

Linear LCD Graphic Panel



LCD monitor not supplied

This unique media stand allows you to merge your graphics with an audio visual message. The screen can be moved vertically and horizontally. An attention grabber for any exhibitions

features & benefits

- Portable and easy to assemble
- Anodised aluminium construction
- 75mm round modular post system as standard
- Available in 3 different sizes: 2000mm(h) x 1000mm(w), 2000mm(w), 3000mm(w)
- Steel oval bases supplied as standard



Recommended accessories:



Linear standard shelf - LN130



LED Flood light PS1050
Requires US-LINEAR



Acrylic stacks LN602-LCA

hardware specifications

Hardware dimensions (mm):

2000 (h) x 1250 (w) x 400(d) approx
2000 (h) x 2250 (w) x 400(d) approx
2000 (h) x 3250 (w) x 400(d) approx

LCD hook over bracket max weight:
4kg

graphic size (mm):

Recommended graphic size (mm):

Please refer to graphic template

Assembly Instructions

Linear LCD graphic panel



Male post x 2
(weight 1kg approx)



Steel oval base & M10 bolt x 2
(weight 4kg approx)



PVC clear washer x 1



Allen Key



LCD hook over bracket x1



Female post x 2
(weight 1kg approx)



1000mm beam x 4
(weight 1kg approx)



Linear PVC wing extrusion x 2
(weight 1kg approx)

Please note that the above kit is based on a LK025-C - 2000mm(h) x 1000mm(w) x 400mm(d)

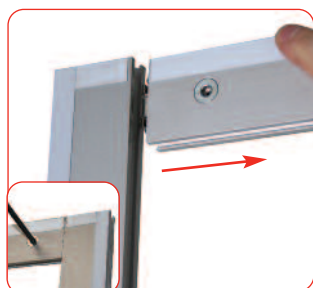

Attach horizontal beams to the vertical frame sides. Tighten locks using a 5mm allen key. If using rigid infill graphics, slide these in to position before tightening beams.



To attach the LCD bracket, hook the bracket over the linear beam and the tighten thumb screw until fully secure



To attach the PVC wing simply cut the PVC wing to the required length, click the PVC wing into the channel on the linear until fully secure

Important: Once frame is complete apply steel tape around the frame and PVC extrusion

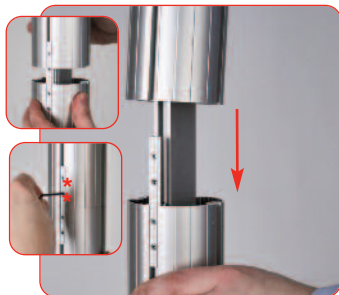

Align and slide female post over male post, tighten both grub screws using a 2mm allen key.



Attach base to male post using M10 bolt and allen key. Ensure clear washer is between base & post. Repeat step for 2nd post.